



PASSPORT ACADEMY

CHARTER SCHOOL

#WATS

PROJECT INTRODUCTION

PASSPORT ACADEMY @ 1835 FORBES AVE

MARCH 30, 2026

WILDMAN
CHALMERS
DESIGN

1622 LOWRIE STREET
PITTSBURGH, PA 15212
412-436-9303
www.wildmanchalmers.com



PROJECT ADDRESS:

1835 FORBES AVENUE
AT GIST STREET

PROPOSED CHANGE OF USE CLASSIFICATION:

- Change of Use from an existing B – Business use classification to E – Educational

BUILDING HISTORY:

- Originally residential rowhouses (per the 1898 and 1923 Hopkins maps), the site was a parking lot as of 1992 (per a Certificate of Occupancy on File with PLI). It was a trade school in the 1970s.
- The existing building was constructed in 1996 as offices and a training center for The Program for Female Offenders
- The building was converted to medical office suites in 2007; it is currently mostly vacant

PROPOSED SCOPE OF WORK:

- Interior renovations as required for educational spaces, including:
 - Classroom/learning support configurations
 - New interior finishes
 - Upgraded electrical and mechanical systems for educational use
- Potential clerestory windows for maximizing daylight, but otherwise minimal exterior work
- New monumental sign to replace the existing
- No proposed work to the existing parking lot or site/landscape, other than as required by the local Authorities Having Jurisdiction



ORIGIN OF PASSPORT ACADEMY

- The vision for Passport Academy originated from the Board of Directors of the Hill House Association in 2013 in response to a lack of programming to support high-risk students from families in poverty; especially those residing in the Hill District.
- The board determined a need to create an alternative option to traditional secondary school options for those who did not find success.
- In discussing the mission of the school, the Board determined the need for such a program that would support students academically and include a career-ready component that would also lead to a high school diploma.

ABOUT PACS

- We are a public charter school (Not an approved private placement)
- We support students 16-21 years old from 15(+/-) Districts
- School is in its 12th year
- Enrollment periods (Summer/Fall-ends October 3rd) Winter (December/January-ends February)
- We have graduated more than 700 students since our school was founded
- Enrollment ranges from 125-150
- Small class sizes
- School is historically accessible by public transportation
- We offer a flexible model to support students:
 - Personalized Schedule
 - 2 in person sessions per day (AM-8:30-11:30, PM 12:30-3:30)
 - 3 hours of in person instruction and 2.5 hours of ANYTIME Learning





Previous Location 2019



Original Location of the School



Temporary Space 2026



Our New Home 2027



**RICHARD
KING MELLON**
FOUNDATION

ECONOMIC MOBILITY

Passport Academy Charter School

toward support to develop a career-pathways curriculum focused on preparing students for family-sustaining employment in the region



Study goals



Identify existing evidence on promising approaches for building career-oriented competencies in alternative high schools

Examine capacity and current practices of PACS



Identify occupations that pay a family-sustaining wage in the Pittsburgh region and skills and credentials associated with these occupations

PA Career Cluster

Typical Education

Architecture and Construction

HS/Post-Sec. Cert.

Manufacturing

HS/Assoc. Degree

Health Science

Associate's Degree

Transp., Distribution, and Logistics

HS/Post-Sec. Cert.

Arts, A/V Tech and Communication

HS

Business and Administration

HS

Gov. and Public Administration

HS

Law and Public Safety

HS/Assoc. Degree

Agriculture, Food and Natural Resource

HS

Marketing Sales and Service

HS

INDUSTRIAL ARTS WORKSHOP

DIGITAL DAILY GOOGLE NEWS PANEL PITTSBURGH NEWS/METRO

Teaching art through welding: All-female high school student cohort at Passport Academy takes welding classes

By Rob Taylor Jr. - Courier Staff Writer February 2, 2024 594



PITTSBURGH TRADE INSTITUTE



CARNEGIE MELLON ROBOTICS PRE-APPRENTICESHIP



NEW CENTURY CAREERS



CNX MENTORSHIP ACADEMY





EXISTING
PARKING LOT
[43 SPACES]

PROXIMATE TO:

- Duquesne University / Medical School
- Point Park University
- UPMC Mercy

BUS STOP:

Fifth Ave Opp.
Gist Street
(3150)
61A, 61B, 61C,
71B Inbound

**EXISTING BUILDING
TO REMAIN**

BUS STOP:

Forbes Ave at Gist
Street (3248)
61A, 61B, 61C, 71B
Outbound

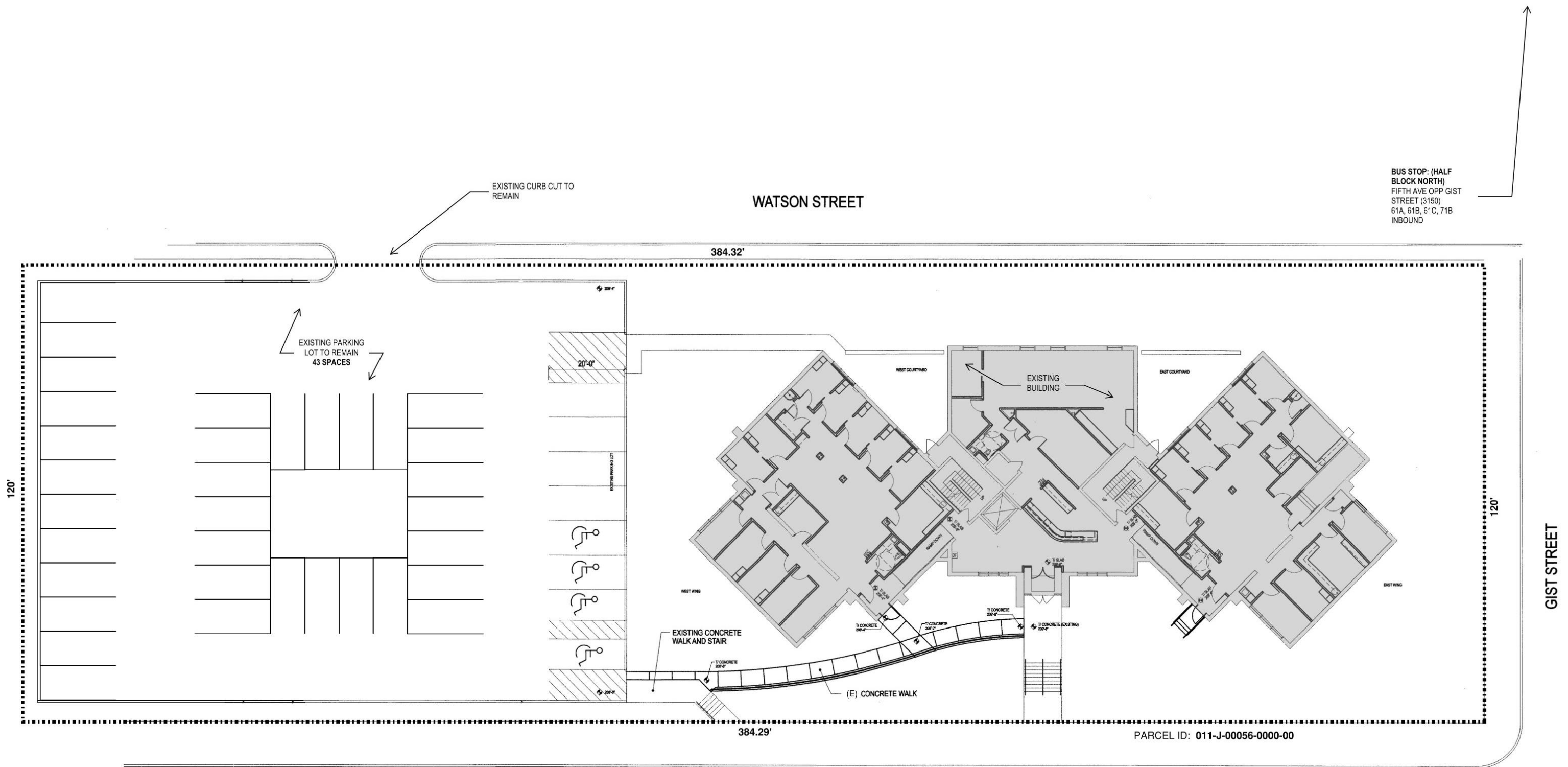

1 SITE PLAN
1/16"=1'-0"

- Students use public transportation to get to school: no bussing is provided except for occasional small group trips to off-site training programs. A shuttle mini-bus will pick students up in the parking lot.
- 2 in person sessions per day:
 - AM: 8:30-11:30 am
 - PM: 12:30-3:30 pm
 - No more than 80 students in the building per session
- 18 staff members may park in the parking lot, though biking to work or using public transportation are encouraged (a shower will be provided)
- Designated visitor parking spaces will be provided, so no additional parking demand will be placed on the streets
- School does not provide meals (other than healthy snacks), so deliveries are limited to occasional supplies.

THANK YOU!



PASSPORT ACADEMY

CHARTER SCHOOL

**WILDMAN
CHALMERS**
D E S I G N